

# **RIG 1 SKY TOP 4 AXLE CARRIER**

---

## **6500' DRILLING DEPTH**

### **POWER SYSTEM:**

*Series 60 Detroit Diesel Engine*

*Allison 5860 Transmission*

*(1)125 KW Generator*

*(1)75 KW Generator*

### **DRAW WORKS:**

*Sky Top 4210 (550HP)*

*1" Drill Line*

### **MAST:**

*96' 105 Ton Double Telescoping*

### **BLOCK AND HOOK:**

*McKissick 65 Ton Combo*

### **SWIVEL:**

*Gray Type F 300 Ton*

### **ROTARY TABLE:**

*Ideco 175-F 17.5"*

### **SUBSTRUCTURE:**

*8'H x8'W x 20'L*

*12'x35' Mud Boat*

### **MUD PUMPS:**

*(2) Wilson 600HP Duplex Pumps*

*Each powered by Series 60 Detroit Diesel Engine*

### **CHOKE MANIFOLD:**

*5000 psi with Gas Buster*

### **BOP'S:**

*10" x 3000 psi Ragan Annular*

*11" x 5000 psi WP Shaffer*

### **ACCUMULATOR SYSTEM:**

*Koomey 3-Station, 33 Gallon System*

### **MUD SYSTEM:**

*Earth Pits*

*Electric 4'x5' Shaker*

*5'x8' Mixing Pump*

*(1) Desander Cone*

*(1) Desilter Cone*

### **DRILL PIPE:**

*4½" OD*

### **DRILL COLLARS:**

*As Required*

### **AUXILIARY EQUIPMENT:**

*Tool Pusher & Crew Quarters*

*Pipe Spinner*

*Kelly Spinner*

*0°-7° Drift Indicator*

*500 BBL Water Tank*

*John Deere Hydraulic Power Unit*

*29 CFM Air Compressor*

# RIG PLATFORM 1 6500' DRILLING DEPTH



**NOT TO SCALE**

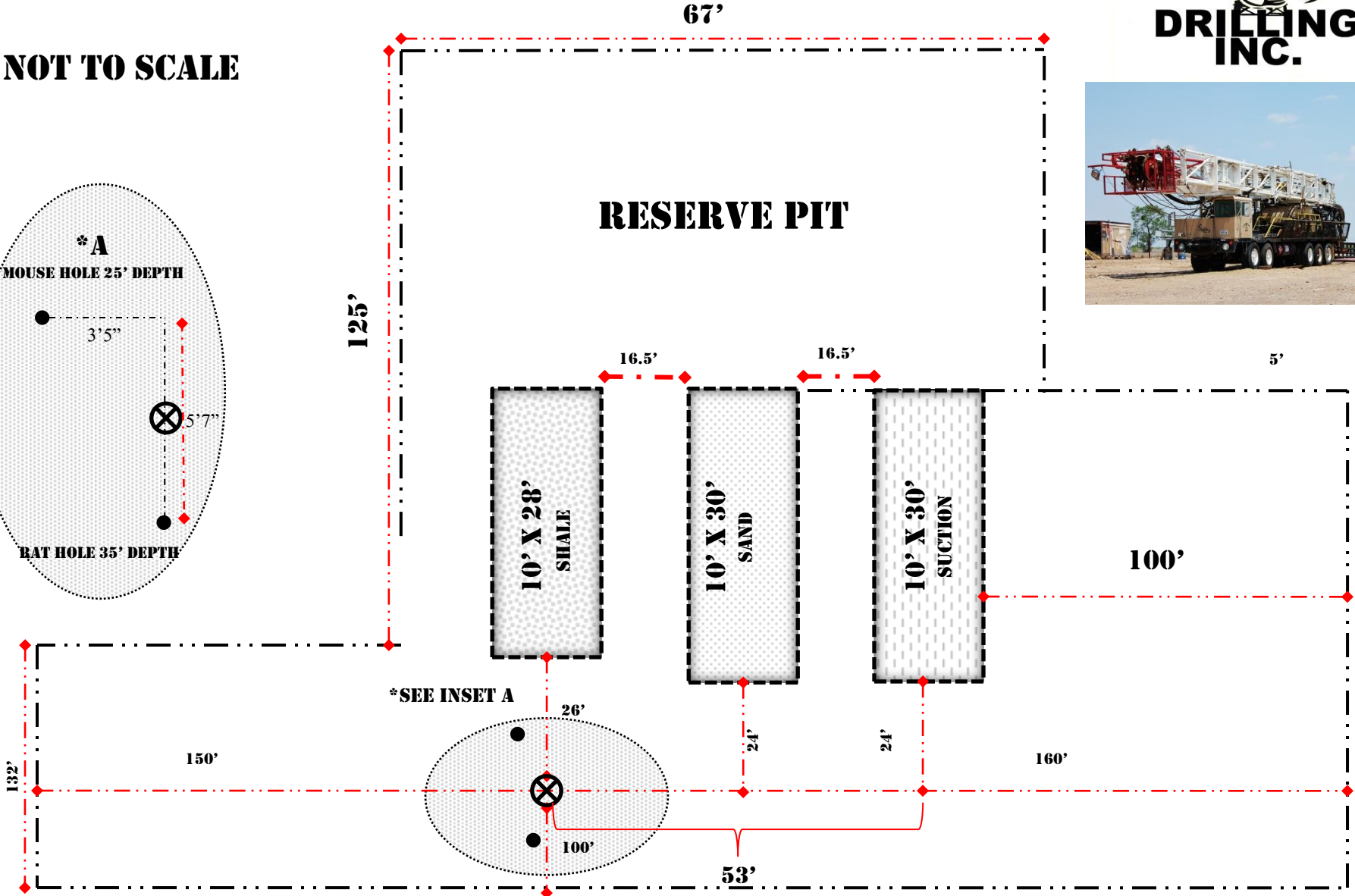

# **RIG 2 SKY TOP 550 HP 4 AXLE CARRIER**

---

## **9200' DRILLING DEPTH**

### **POWER SYSTEM:**

*Series 60 Detroit Diesel Engine*

*5860 Allison Transmission*

*(1)150 KW Generator*

*(1)200 KW Generator*

### **DRAW WORKS:**

*550 Sky Top with 22" Hydromatic Brake*

*1" Drill Line*

### **MAST:**

*105' 125 Ton Double Telescoping*

### **BLOCK AND HOOK:**

*McKissick 150 Ton Combo*

### **SWIVEL:**

*Gray Type F 300 Ton*

### **ROTARY TABLE:**

*Ideco 175-F 17.5"*

### **SUBSTRUCTURE:**

*Sky Top 12' T-Type*

*12'x40' Mud Boat*

### **MUD PUMPS:**

*Emsco F-800 Triplex 6"x9"*

*Emsco D-500 Duplex 7"x16"*

*Powered by Series 60 Detroit Diesel Engine*

### **CHOKE MANIFOLD:**

*5000 psi WP with Gas Buster*

### **BOP'S:**

*10" x 3000 psi Ragan Annular*

*11" x 5000 psi WP Shaffer*

### **ACCUMULATOR SYSTEM:**

*Koomey 3-Station, 33 Gallon System*

### **MUD SYSTEM:**

*(2) Tank 400 Bbl System*

*(2) Cone Desander*

*Swaco Linear Motion Shakers*

*Drillco Atmospheric Degasser*

*4'x5' Centrifugal Pump*

### **DRILL PIPE:**

*4½" OD*

### **DRILL COLLARS:**

*As Required*

### **AUXILLARY EQUIPMENT:**

*Tool Pusher & Crew Quarters*

*Automatic Driller*

*Pipe Spinner*

*Kelly Spinner*

*0°-7° Drift Indicator*

*500 BBL Water Tank*

*John Deere Hydraulic Power Unit*

*29 CFM Air Compressor*

# RIG 2 PLAT 9200' DRILLING DEPTH

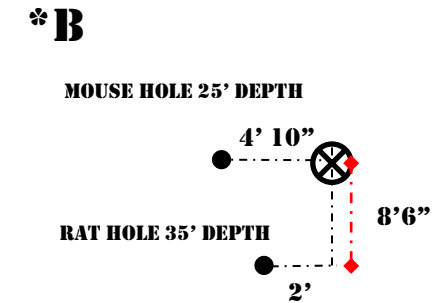
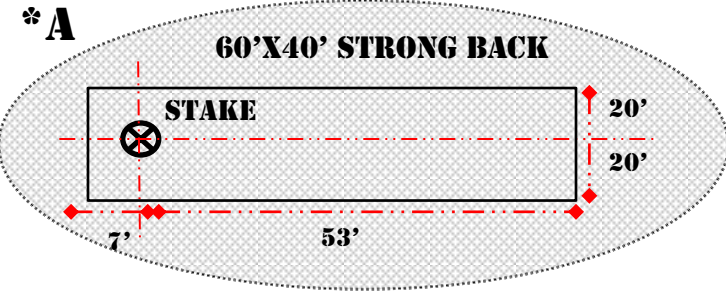

**KB= 12'**

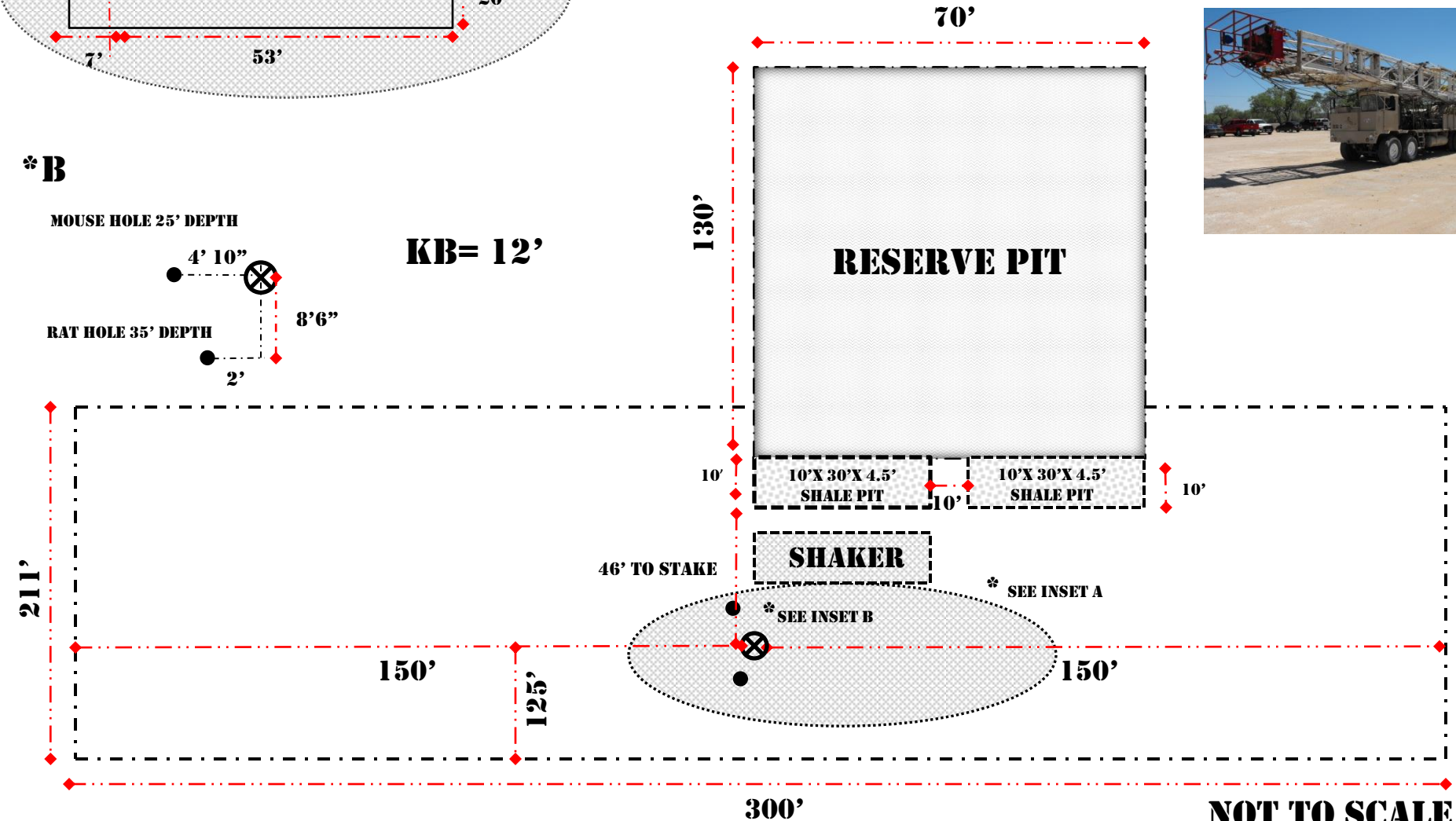

**NOT TO SCALE**

# **RIG 3 750 HP (900 HP EQUIV.) MECHANICAL TRAILER 9500' DRILLING DEPTH**

---

## **POWER SYSTEM:**

*(2) Series 60 Detroit Diesel Engines  
Twin Disc Converter*

*(1) International 250 KW Generator*

*(1) Series 60 350 KW Generator*

## **DRAW WORKS:**

*Brewster N4 Two Engine Compound*

*22" Parksberg Hydromatic Brake*

*1" Drilling Line*

## **MAST:**

*112' 150 Ton SHL*

## **BLOCK AND HOOK:**

*McKissick 150 Ton Combo*

## **SWIVEL:**

*Gray Type 44 500 Ton*

## **ROTARY TABLE:**

*ZF-175 17.5"*

## **SUBSTRUCTURE:**

*Sky Top 12' T-Type*

*12'x40' Mud Boat*

## **MUD PUMPS:**

*Emsco F-800 Triplex 6"x9"*

*Gardner-Denver Triplex PZ-8 8½"x6"*

*Powered by Series 60 Detroit Diesel Engines*

## **CHOKE MANIFOLD:**

*5000 psi WP with Gas Buster*

## **BOP'S:**

*10" x 3000 psi Ragan Annular*

*11" x 5000 psi WP with Double Ram*

## **ACCUMULATOR SYSTEM:**

*Koomey Type 80 5-Station, 55Gallon System*

## **MUD SYSTEM:**

*(2) Tank 400 Bbl System*

*(2) Brandt Desander Cones*

*(2) Linear Motion Shakers*

*Drillco Atmospheric Degasser*

## **DRILL PIPE:**

*4½" OD*

## **DRILL COLLARS:**

*As Required*

## **AUXILLARY EQUIPMENT:**

*Tool Pusher & Crew Quarters*

*Automatic Driller*

*Pipe Spinner*

*Kelly Spinner*

*0°-7° Drift Indicator*

*John Deere Hydraulic Power Unit*

# RIG 3 PLAT 3 9500' DRILLING DEPTH

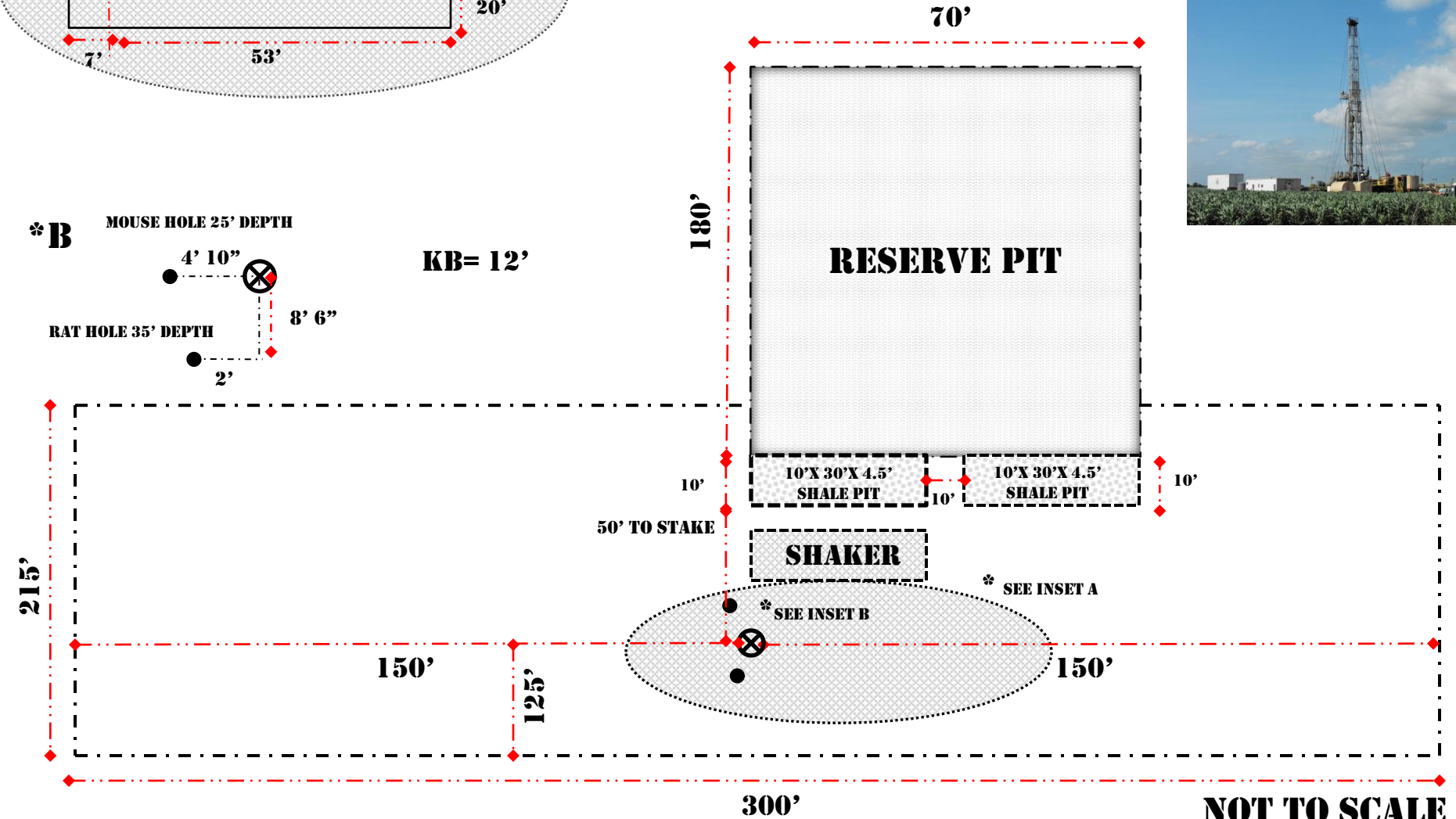
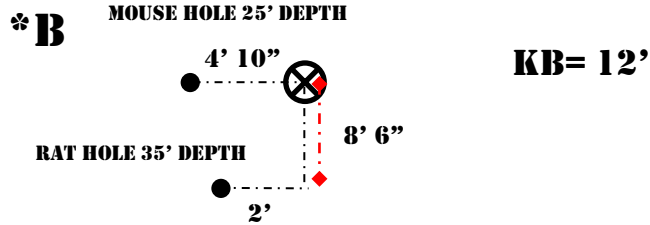
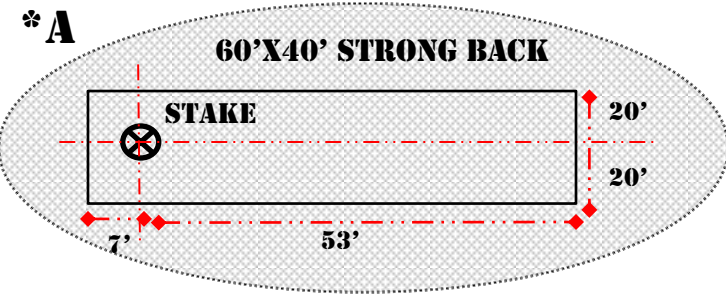

**NOT TO SCALE**

# **RIG 10 MOELLER 42'X10' MODEL D402**

---

## **5 AXLE CARRIER 13,500' WORKOVER DEPTH**

### **POWER SYSTEM:**

*550 HP Caterpillar 3408 Diesel Engine*

*Allison CLT-5860 Transmission*

*22" Double Hydromatic Brake*

### **CARRIER:**

*Hydraulic Leveling Jacks*

*Folding Adjustable Work Platform*

*Stairs and Base Beam*

### **DRAW WORKS:**

*Dragon 104' 125 Ton Static Hook*

*Double Drum, Double Raising Rams*

*Tulsa Hydraulic Utility Winch*

### **BOP'S:**

*7 1/16" x 5000 psi*

*IGA 7 1/16" x 5000 psi (Townson Copy)*

### **MAST:**

*Load Telescoping, Hydraulic Raised and Scoped*

*Standpipe and Mud Hose*

### **TUBING LINE:**

*Lebus F 1" Tubing Line*

*9/16" Sand Line*

### **BLOCK AND HOOK:**

*McKissick 100 Ton 3 Sheave Tubing Block*

### **AUXILLARY EQUIPMENT:**

*Swab Lubricator & Tools*

*2 3/8" & 2 7/8" Elevators*

*Foster Tubing Tongs*

### **SWIVEL:**

*King 75 with Gear Box*

*Cavin B Slips*

*200 Bbl Mud Tank*

*Spool – 7 1/16" 5000 psi*

### **MUD PUMPS:**

*Gardner-Denver Triplex PY-7 Triplex*

*Powered by 550HP Caterpillar Diesel Engine*

*Allison 5860 Transmission*

*5" Liners 120 SPM Max*

*7 1/16" 10,000 psi*

## **DRILLING REFERENCES 2008**

---

### **Aurora Resources**

11 Wells: Colorado, Jackson, Wharton, Victoria, Bee, & Goliad Counties

### **Remora Management**

1 Well: Refugio County

### **Jamex, Inc.**

4 Wells: Live Oak & Colorado Counties

### **Great Bay Operations**

8 Wells: Starr & Refugio Counties

### **Kebo Oil & Gas**

4 Wells: Jim Wells, Bee, & Starr Counties

### **Rock Resources, Inc.**

1 Well: Goliad County

### **Anderson Oil, Ltd**

5 Wells: Bee, Jim Wells, & San Patricio Counties

### **Mission River Systems**

2 Wells: Nueces County

### **Finley Resources**

1 Well: McMullen County

### **Ginger Oil Company**

1 Well: Jackson County

### **Wallis Energy**

4 Wells: Aransas County

### **Sue-Ann Operating**

2 Wells: Nueces County

### **Saxum Oil & Gas**

2 Wells: Bee County

### **Great Texas Crude, Inc.**

1 Well: Jim Wells County

## **DRILLING REFERENCES 2009**

---

### **Anderson Oil, Ltd**

4 Wells: Bee & Refugio County

### **Saxum Oil & Gas**

3 Wells: Bee & Kenedy Counties

### **Kebo Oil & Gas**

5 Wells: Refugio, Jim Wells, & Live Oak Counties

### **Sue-Ann Operating**

1 Well: Refugio County

### **Durango Resources**

2 Wells: Nueces County

### **Riddle Engineering Corp.**

3 Wells: Wharton & Nueces Counties

### **Voyager Oil & Gas**

1 Well: Duval County

### **Aurora Resources**

1 Well: Wharton County

### **Harper Hefte, Inc.**

2 Wells: McMullen & Nueces Counties

### **Miramar Petroleum**

1 Well: Willacy County

### **New Century Exploration**

4 Wells: Colorado & Wharton Counties

### **Tauber Exploration & Production**

1 Well: Jim Wells County

### **Spirity Energy, LLC**

1 Well: Zapata County

### **Gasper Rice Resources, Ltd**

3 Wells: Duval & Jim Wells Counties

### **Cummins & Walker Oil Co., Inc.**

1 Well: Jim Wells County

### **Liberty Pioneer Energy, Inc.**

1 Well: Starr County

### **Jamex, Inc.**

1 Well: Live Oak County

## **DRILLING REFERENCES 2010**

---

### **Riddle Engineering Corp.**

3 Wells: Kenedy & Goliad Counties

### **Dewbre Petroleum Corp.**

5 Wells: Brooks, Hidalgo, Kenedy, Live Oak, & Webb Counties

### **American Shoreline Inc.**

1 Well: Duval County

### **Cinco Natural Resources, Inc.**

1 Well: Live Oak County

### **Kebo Oil & Gas**

9 Wells: Brazoria, Jim Wells, Live Oak, Matagorda, & Refugio Counties

### **Gasper Rice Resources, Ltd**

3 Wells: Bee & Nueces Counties

### **Harper Hefte, Inc.**

1 Well: Atasosa County

### **Sue-Ann Operating**

4 Wells: Fort Bend, Lavaca & Victoria Counties

### **Crossroads Energy, LP**

1 Well: Lavaca County

### **Liberty Pioneer Energy Services**

4 Wells: Starr County

### **Anderson Oil, LTD**

2 Wells: Bee County

### **C.J. Wofford**

1 Well: Lavaca County

### **BP Production**

1 Well: Victoria County

### **Rodessa Operating/Everest Resources**

1 Well: Victoria County

### **Progas Energy Services**

3 Wells: Jim Wells County

### **Ricochet Energy, Inc.**

1 Well: Galveston County

### **Aurora Resources**

4 Wells: Duval & Jackson Counties

### **Voyager Gas Corporation**

1 Well: Duval County

### **P-R-O- Management**

1 Well: Nueces County

### **Texas Sabal, Inc.**

1 Well: Duval County